

Park Pilot Magazine
Mitsubishi A6M2 Zero
 Wingspan : 30" Length: 21.6"
 Designed And Drawn By Andy Reynolds
 July 28, 2011 Sheet 1 of 1

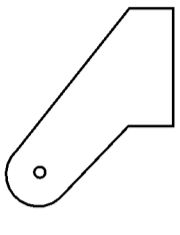

1/16" ply control horns

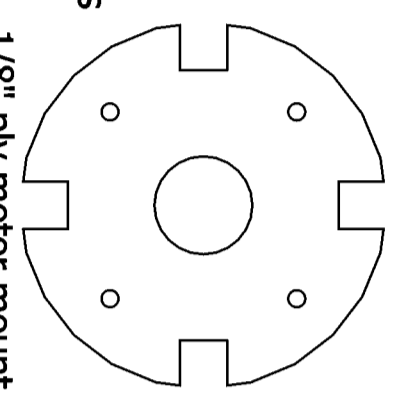

1/8" ply motor mount

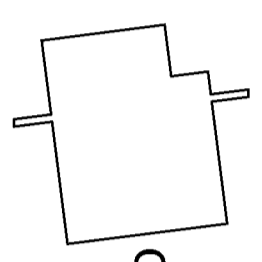

Cut holes to fit 5g or 9g aileron servos

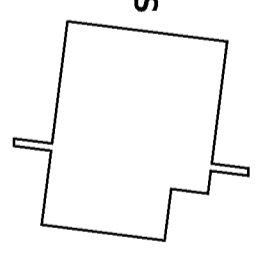

Cut holes to fit 5g or 9g aileron servos

Wing

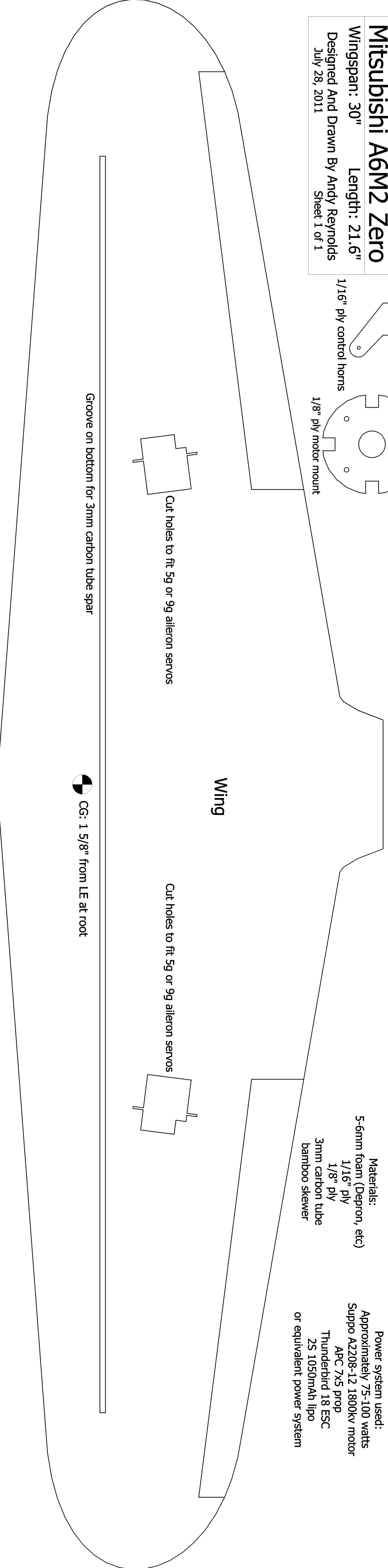

Groove on bottom for 3mm carbon tube spar

CG: 1 5/8" from LE at root

Materials:
 5-6mm foam (Depron, etc)
 1/16" ply
 3mm carbon tube
 bamboo skewer

Power system used:
 Approximately 75-100 watts
 Suppo A2208-12 1800kv motor
 APC 7x5 prop
 Thunderbird 18 ESC
 2S 1050mAh lipo
 or equivalent power system