

system used:
75-100 watts
1800kv motor
5 prop
18 ESC
30mAh lipo
power system

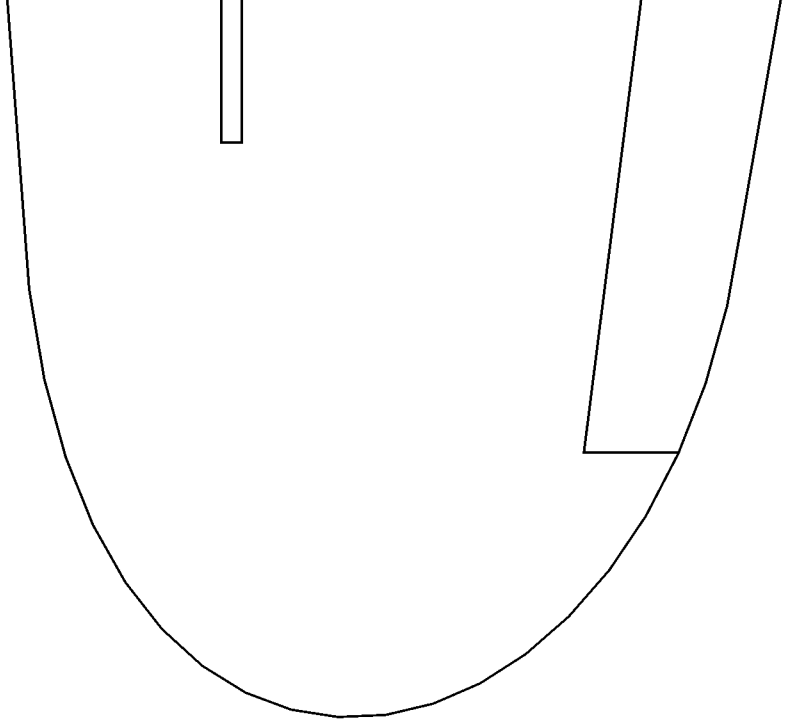

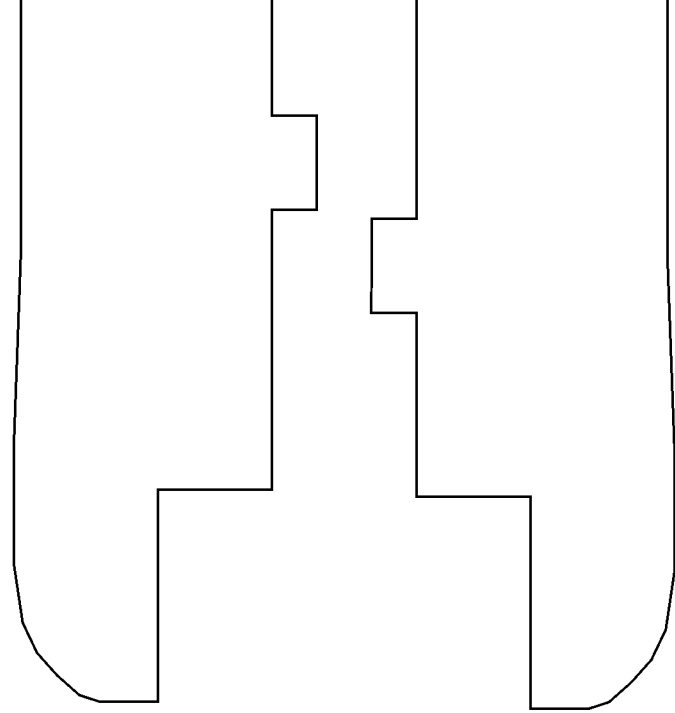
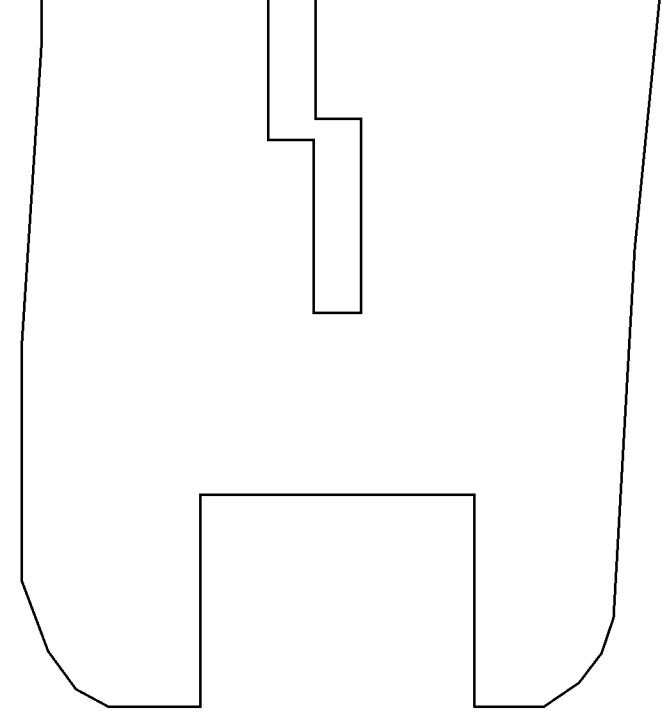

Materials:
5-6mm foam (Depron, etc)
1/16" ply
1/8" ply
3mm carbon tube
bamboo skewer

Power sy
Approximate
Suppo A2208-
APC 7
Thunder
2S 105
or equivalent

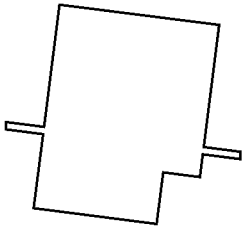

for 9g aileron servos

Left Horizontal Fuselage

Right Horizontal Fuselage

Vertical Fuselage





Wing

for 9g aileron servos

Cut holes to fit 5g servo

spare



CG: 1 5/8" from LE at root



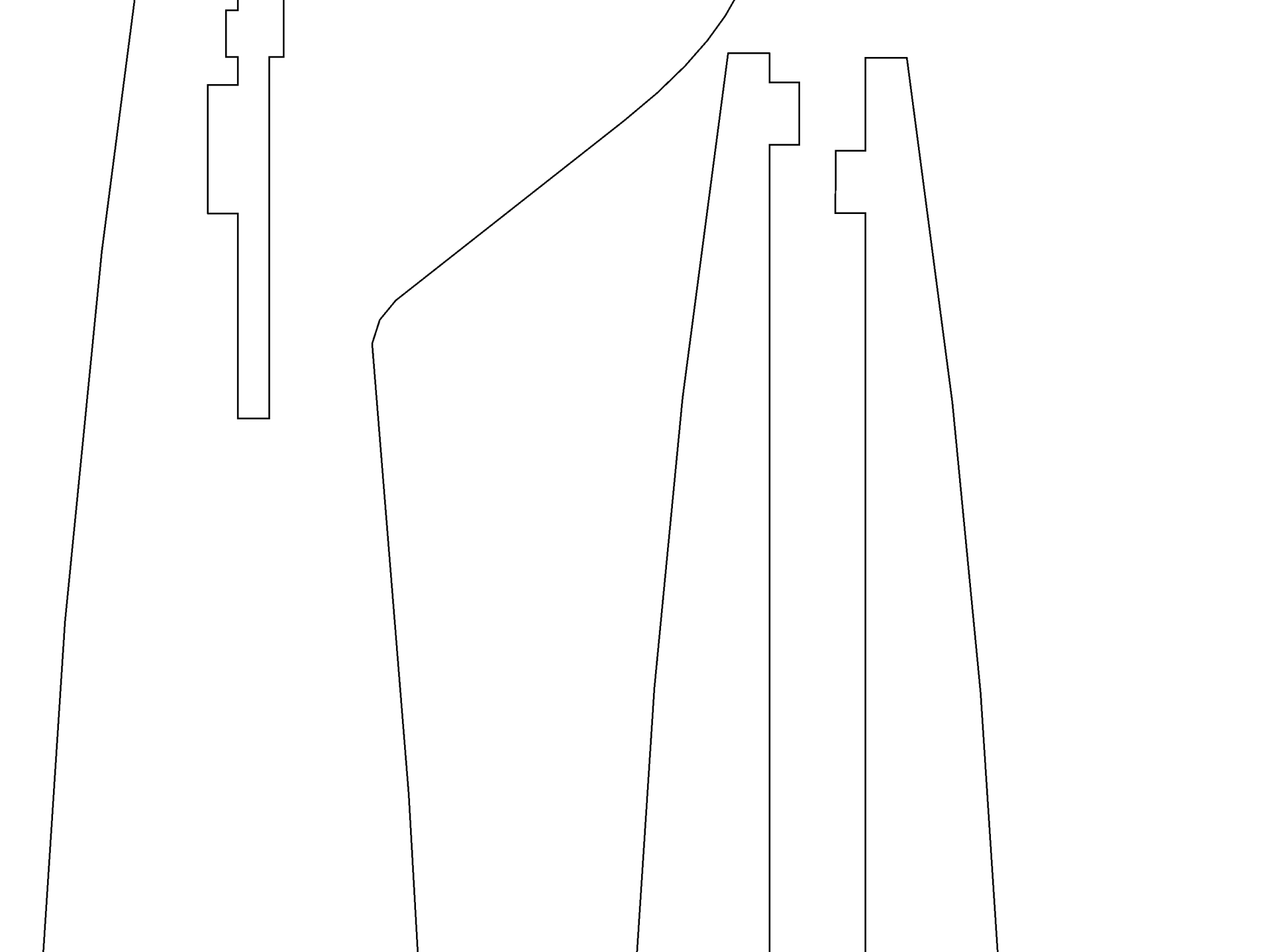

Line

2 Zero

Depth: 21.6"

ply Reynolds

Sheet 1 of 1

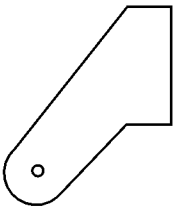

1/16" ply control horns

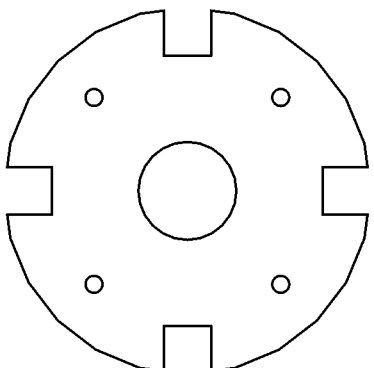

1/8" ply motor mount

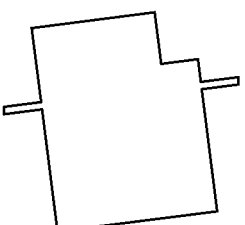

Cut holes to fit 5g

Groove on bottom for 3mm carbon tube

4"

5"

6"

skewer joiner

Filler between
elevators

Horizontal stab and elevator

Optional rudder cutout.
Don't cut if you aren't installing a rudder.

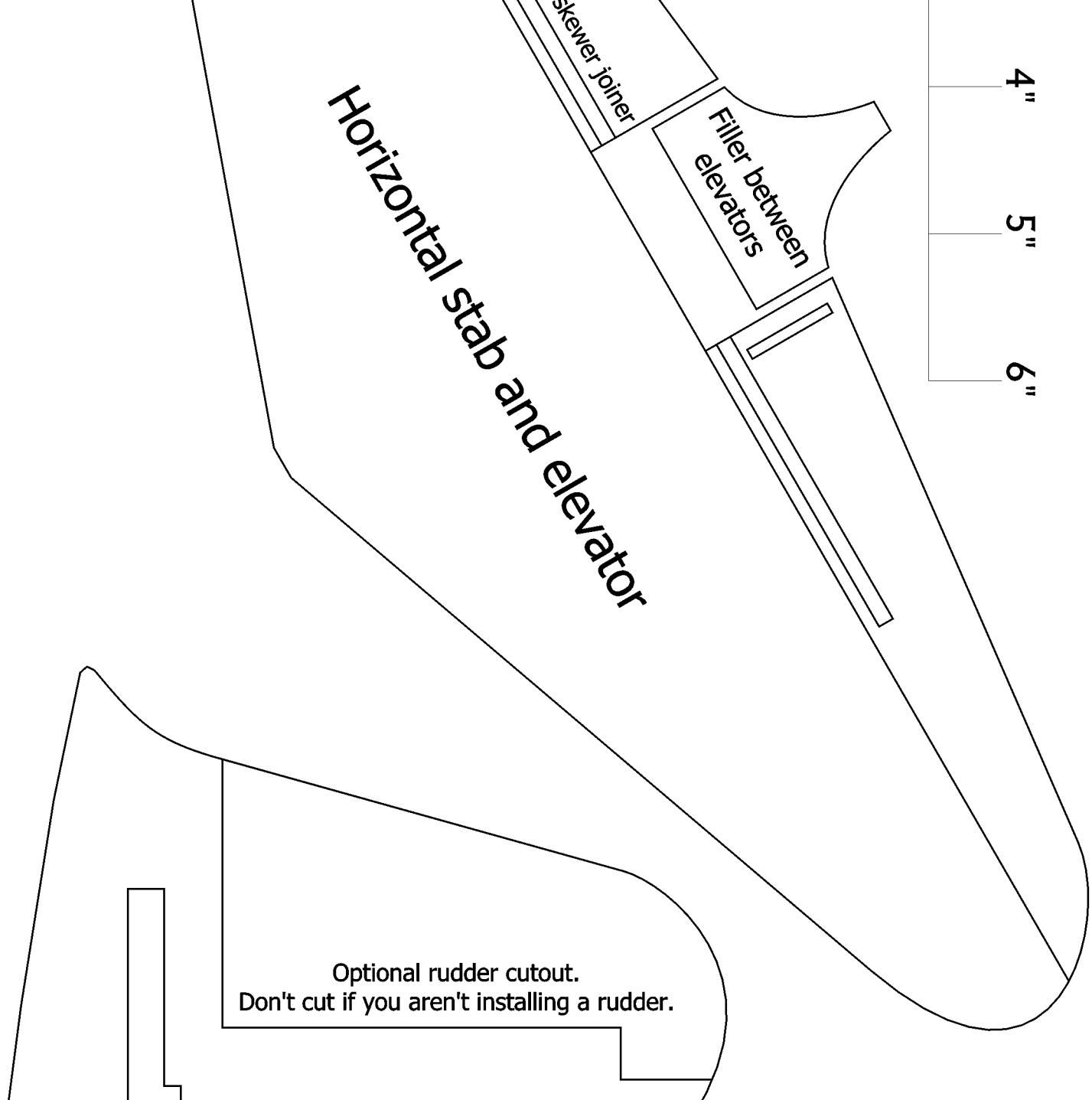

Park Pilot Magaz
Mitsubishi A6M2

Wingspan: 30" Leng

Designed And Drawn By And
July 28, 2011 S

